

Green Industry Education's



Sustainable Landscape Project

This project will assess a residential landscape, design a sustainable landscape, perform site preparation and planting of new sustainable landscape. All phases of this project will be documented on video and used to create a new online training session.

Project Co-chairs:



William Baker (William Baker and Associates) - Certified Golf Course Superintendent, Certified Arborist, licensed pest control advisor, pesticide applicators license.



Janet Hartin (University of California Cooperative Extension) - B.S. and M.S. degrees from the University of Minnesota, Environmental Horticulturist specializing in sustainable landscapes.



Susan Sims (Sims Tree Learning Center) - Agricultural Biologist, ISA Board Certified Master Arborist, CA Certified Urban Forester, CA Licensed Agricultural Advisor, CA Licensed Agricultural Applicator

Sponsorships Available:

- Soil Amendments
Gail Materials
Tri-C Enterprises
- Hardscape
Gail Materials
- Irrigation System
Toro
Little Valve
- Plant Material
Available
- Turf
Stover Seed Company
- Synthetic Putting Green
Available

Sponsorships Include:

- Banner Advertising at GreenIndustryEducation.com
- Product Feature at LandsMagazine
- Sponsored Product Release on Green TV
- Logo Recognition in Sustainable Landscapes column in Landscape and Irrigation Magazine
- Logo Recognition in Online Training Session
- Logo Recognition on Session Print Advertising
- Speaking Opportunity in Online Training Session "Sustainable Landscapes"
- Online Exhibit at LandsExpo.com

Contact: Steven Jay Porus, Green Industry Education

sjporus@greenindustryeducation.com • Phone 818-764-6222 • Mobile 818-266-3521

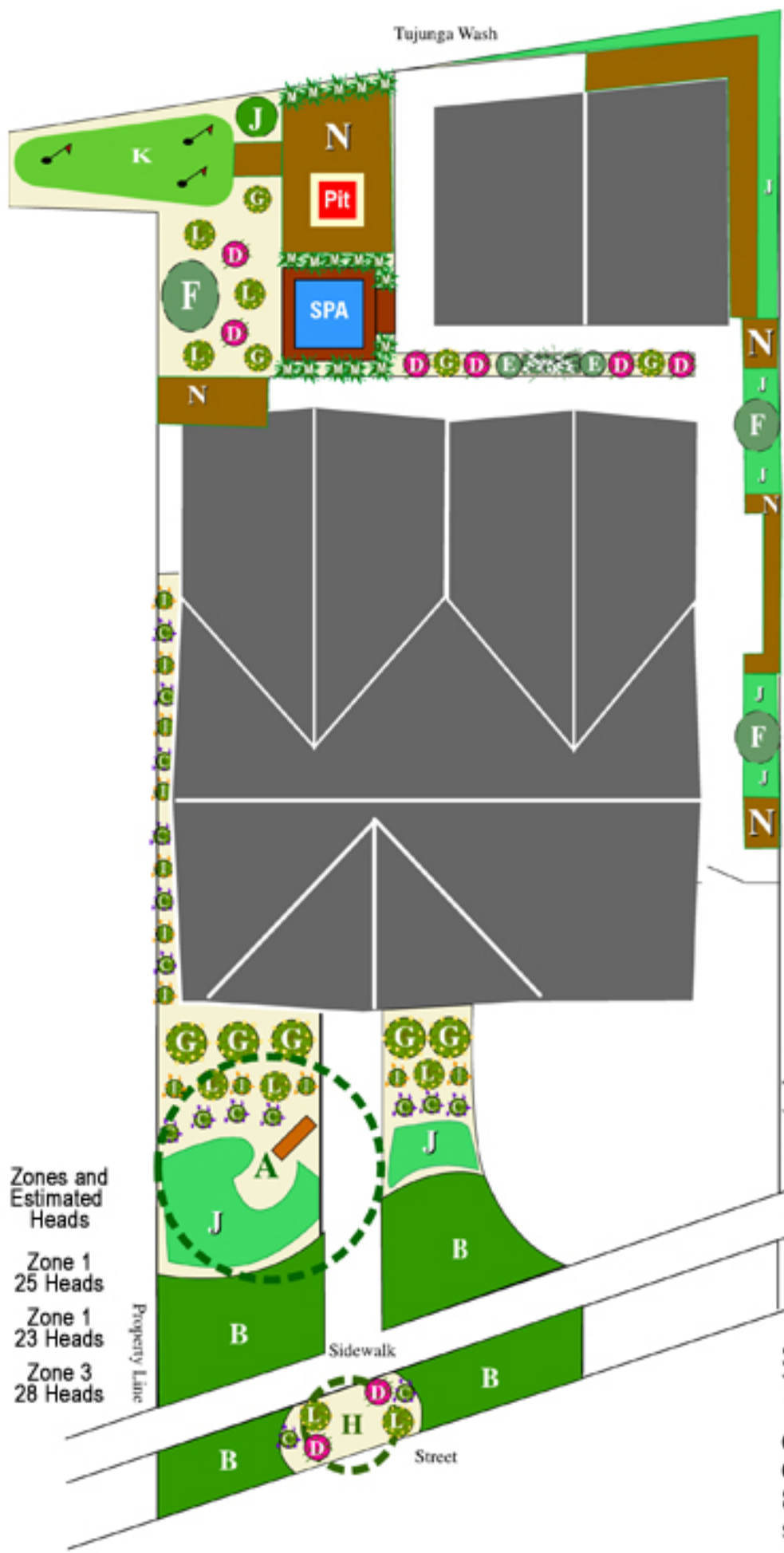

Zones and Estimated Heads

- Zone 1 25 Heads
- Zone 1 23 Heads
- Zone 3 28 Heads

Green Industry Education's
 Sustainable Landscape Project • 2007

Sponsors







Landscape Notes:(For Layout Only)

- A: Magnolia Grandiflora (Existing)
 - B: Dwarf Tall Fescue Grass
 - C: Linope Muscari
 - D: Lavender
 - E: Trellised Vine
 - F: Hollywood Juniper
 - G: Fortnight Lily
 - H: Crape Myrtle
 - I: Coreopsis
 - J: Groundcover
 - K: Synthetic Putting Green
 - L: Lavender Cotton
 - M: Various Tall Grasses
 - N: Pavers
- White = Concrete Drive and Sidewalks

Property Line

4'0"
6'0"

SmartScapes 2007
 Van Nuys, CA 91405

Contact: Steven Porus
 Green Industry Education
 818-266-3521
 sjporus@greenindustryeducation.com